

SL764+ | SL787+

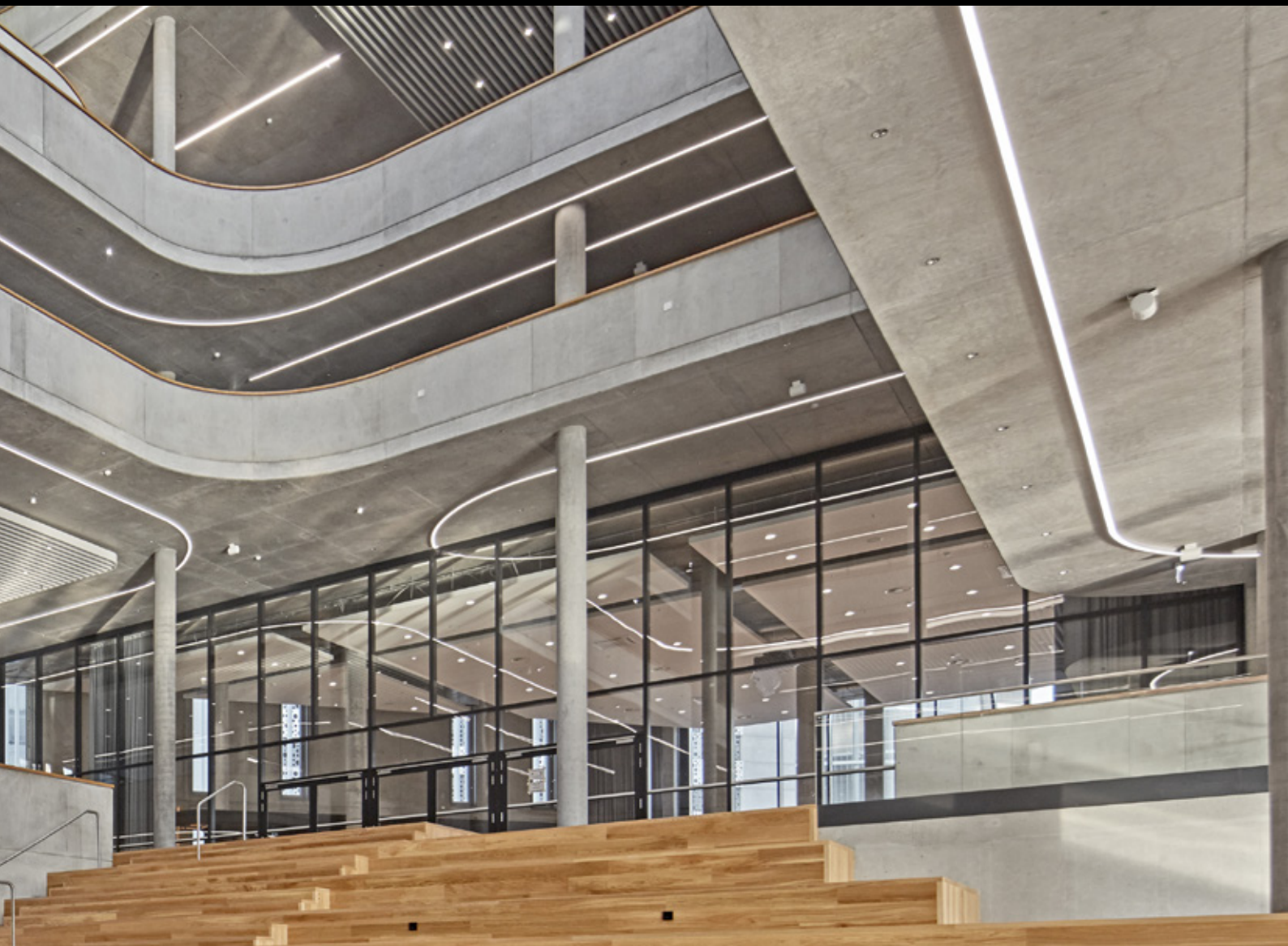

PERFORMANCE
iN LIGHTING

powered by
GEWISS

SL764+ | SL787+



Two profiles - endless possibilities

A limited number of combinable factors create an almost infinite range of product variants. Our SL764+ and SL787+ lighting systems are a shining talent throughout the entire office, education and administration sector. The lighting systems and the associated individual luminaires are characterised by a clear and linear design language that adapts aesthetically and also discreetly to any architecture.

The lighting systems offer maximum design freedom in terms of dimension, capacity, shapes, installation types, lighting technology and sensors and provide the option to implement a uniform photometric concept throughout the building.

Due to the mostly very individual and complex requirements for intelligent, versatile and energy-efficient lighting systems, their planning and installation is often very demanding and time-consuming. Here, our award-winning planning tool, LIGHTPERFORMER®, is the optimal solution. With this tool, even complex lighting systems can be configured to suit your needs within just a few minutes, including a light calculation in Dialux.

SL764+

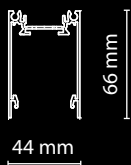

SL764+ PL

max 1.860 lm
max 12 W
L80B10@50000h

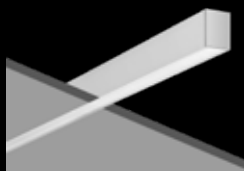

SL764+ RE

max 1.860 lm
max 12 W
L80B10@50000h



**SL764+
LIGHTING SYSTEM**

max 7.180 lm
max 51 W
L80B10@50000h

SL787+

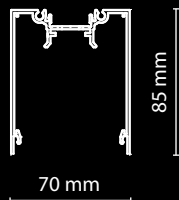

SL787+ PL

max 1.910 lm
max 12 W
L80B10@50000h

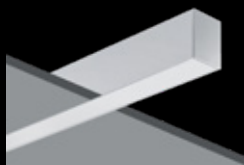

SL787+ RE

max 1.910 lm
max 12 W
L80B10@50000h



**SL787+
LIGHTING SYSTEM**

max 5.010 lm
max 36 W
L80B10@50000h

STANDARD SOLUTIONS

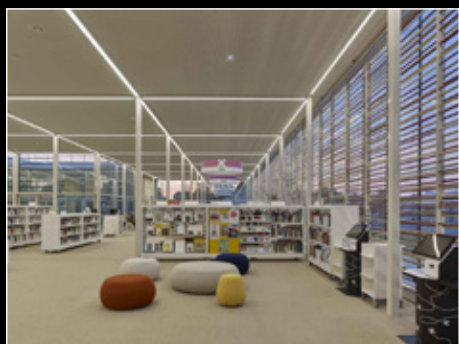

CUSTOMIZED SOLUTIONS

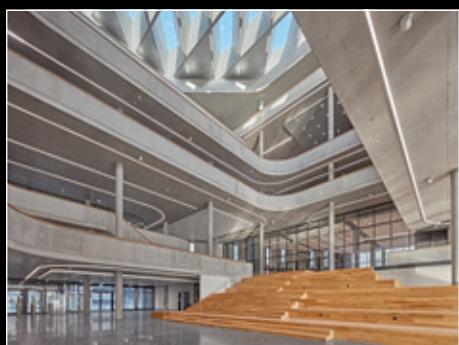

At a glance

3 Colour temperatures

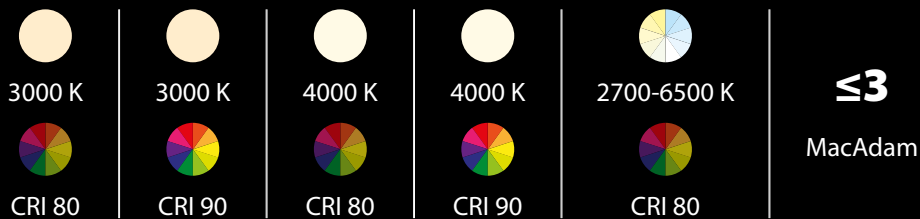

3 Performance levels

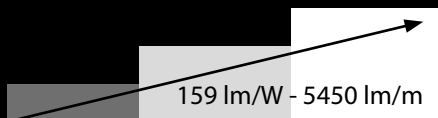

2 Operating units



3 Light optics

Opal

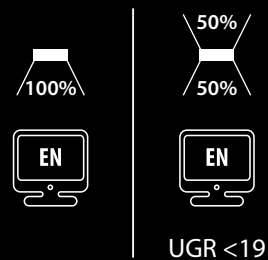

Microprisma

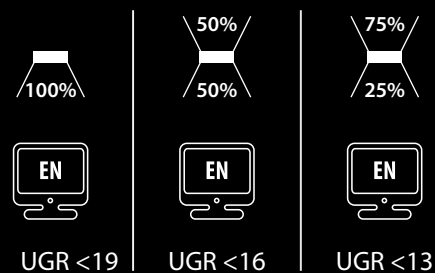
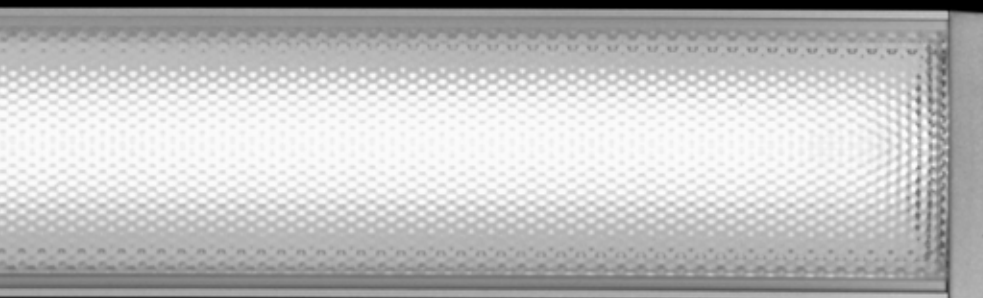

Louvre

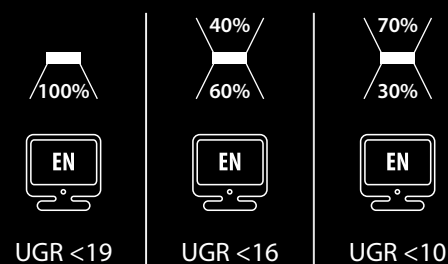

5 Mounting types

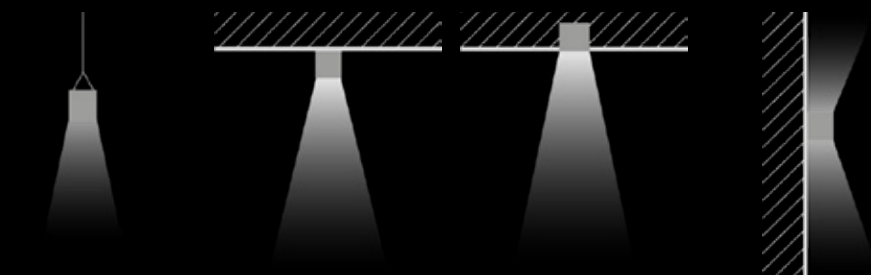

6 System designs

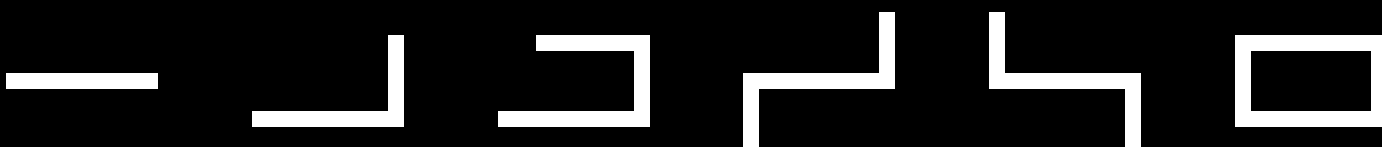

3 Housing colours

GR-EV1



BK-RAL9005

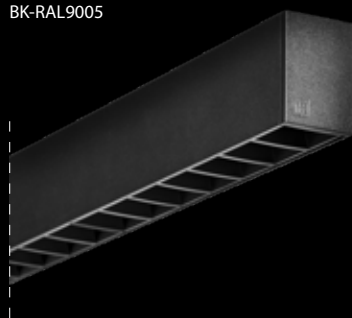

WH-RAL9016



2 Accessories

Conductor rail

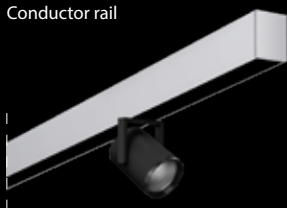

Blind cover

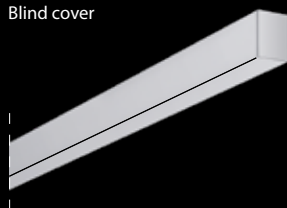

9 Profile lengths

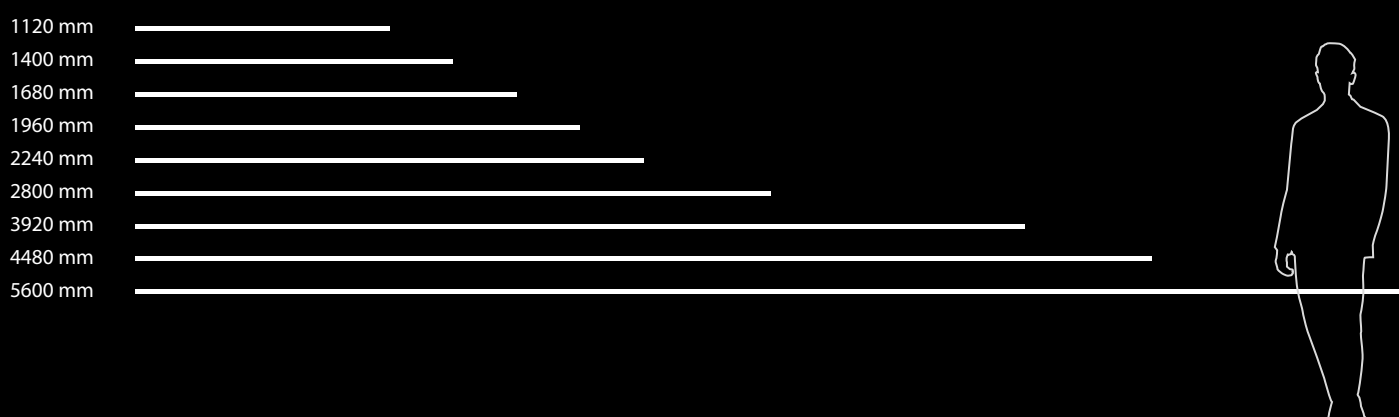

Advantages

One-person installation



Simple and secure thanks to the unique installation aid.

100% homogeneous



Consistent light projection without visible LED dots or spiral formation across the entire light-emitting surface.

Future-proof & Sustainability



All components can be replaced at a later date.

The packaging is 100% recyclable.

Efficient



Up to 159 lm/W thanks to highly efficient LED modules and innovative reflector technology.

Clear design language

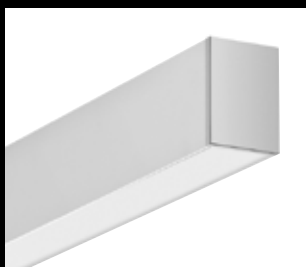

Clear design language thanks to flush end caps.

Perfect integration of the light optics thanks to recesses.

Computer workstations



Versions with anti-glare protection according to DIN EN 12464-1 and UGR<19 are available.

Strip lights up to 25 m



Strip lights without optical interruptions possible up to a length of 25 m. Individual lengths of up to 5.6 m are possible without cutting.

Easy installation

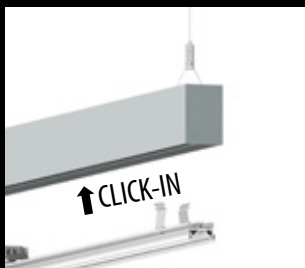

Intuitive and easy luminaire installation in no time thanks to intelligent „CLICK-IN“ technology.

Illuminated corners

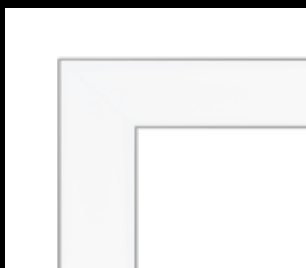

The corners of the system are 100% illuminated, both directly and indirectly.

Light planning

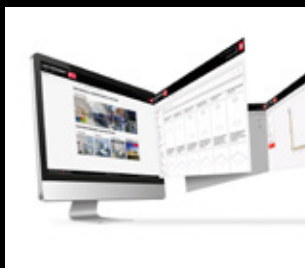

Planning customised lighting systems in just 5 minutes is simple with our award winning LIGHT-PERFORMER®.

LIGHT-PERFORMER®

Light planning has never been so easy!

The Light-performer® configuration tool provides all the answers to your questions. Visit www.light-performer.com for quick and easy access to information and data, photometric files, prices and typical lighting configurations.

Light-performer® was awarded the iF Design Award 2018 in the Communication, Apps/ Software category: Here, you will find all the materials in our entire standard product portfolio. Light-performer® also allows you to individually configure even complex lighting systems in just a few minutes. The program provides you with all the data you need to make your choice: data sheets, DXF drawings, installation instructions and gross prices. A special feature in Light-performer® allows you to generate the appropriate light calculation file for your lighting system in .ULD and .ROLF format or as a Revit file.

In a couple of clicks, you can export the photometric files to light planning software. No more onerous research or tedious waiting for prices: your project can be quickly and conveniently planned, thanks to Light-performer®!

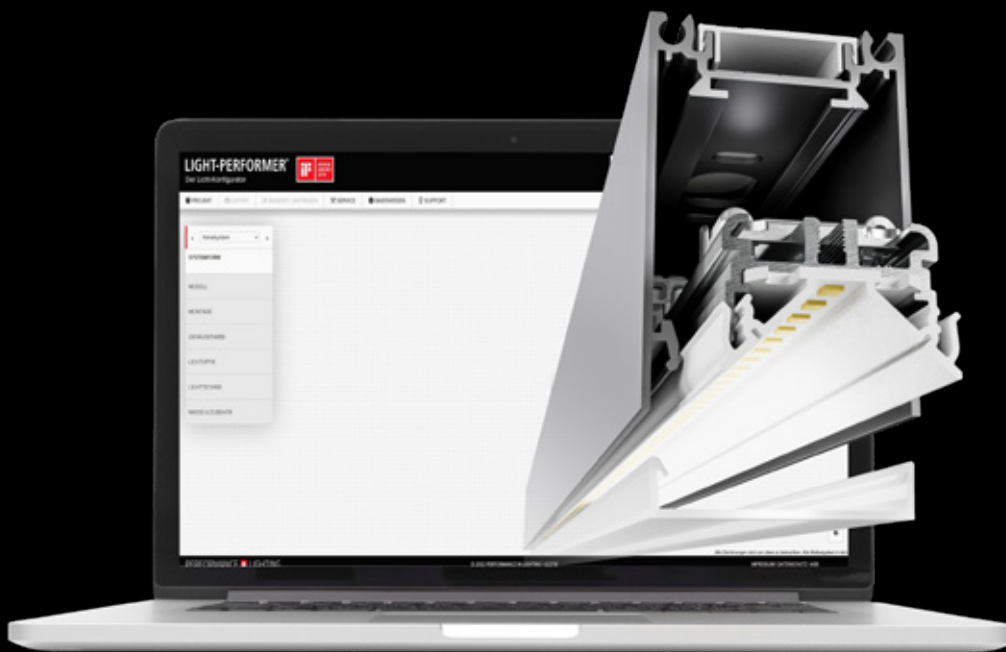

Configured in 7 steps!

1. System design
2. Model
3. Installation
4. Housing colour
5. Light optics
6. Lighting technology
7. Dimensions & accessories

www.light-performer.com

GOOD REASONS FOR CHOOSING US



Use of leading brands for electronic components.



Five-year warranty on the entire luminaire, extendable up to ten for special projects.



Clear conditions, real lumen indicate the luminous flux output of the luminaire.



Wide range of lighting solutions for the most varied applications, all from a single supplier.



Internal laboratories approved by third parties (CTF Stage 2 and WTDP). Ecodesign-EPREL compliance. Company with ISO 9001 quality management system.



The products with die-cast aluminium body with polyester powder finish after surface chemical conversion treatment in compliance with ISO 9227 and ISO 12944, are resistant to corrosion and suitable for C5 areas (ISO 9223).

FUTURE PROOF ►►

"Future-Proof" products with longer life LEDs and replaceable lighting systems for future upgrades. Exceptional longevity and savings with a real contribution to the circular economy.



BIM ready for projects with Dialux, Relux, Litestar software and Autodesk® Revit® Building Information Modeling (BIM) software.



Pre and post sales technical support and lighting consultancy to meet assorted needs, even the most demanding calls for tenders.



Creating connections between people and objects. A flexible and scalable offer, with connected devices that communicate with each other to create tailor-made solutions for every need.



GEWISS offers services in which all aspects of a project are followed, acting on behalf of the customer, from design to procurement, to the coordination of contractors and suppliers up to final delivery.



EcoVadis certification, bronze medal in recognition of the achievements in sustainability.

PERFORMANCE in LIGHTING S.p.A
Viale del Lavoro 9/11
37030 Colognola ai Colli (VR) - Italy
T +39 045 61 59 211
F +39 045 61 59 393

www.performanceinlighting.com