

# NOTTURNO 1000

Part number 304913



## Description

Wall-mounted LED luminaire, comprising:

- Extruded anodised aluminium housing
- Toughened, glass diffuser, silk-screened on the inside
- Stainless steel AISI 304 end caps
- Aluminium heat sink
- For luminaire installation, please select the appropriate bracket (available as mandatory accessory)
- Dimmable DALI options available. Consult factory

## Product data

ETIM Group:	EG000027	ETIM Class:	EC002892
-------------	----------	-------------	----------

## General information

Lampholder:	LED	Light source:	LED
Lightsource lumen output [lm]:	4032	Luminaire lumen output [lm]:	3088
Luminaire wattage [W]:	38 W	Luminous efficacy [lm/W]:	81
CRI:	80	Colour temperature [K]:	4000
Colour / Finishing:	GR-11 / Anodised grey / Matt	IP degree of protection:	IP66
Impact resistance / impact energy:	IK07 2J xx5	Protection class:	III
Optic:	ELL - Elliptical	Beam angle:	13°x36°
Net weight [kg]:	2.092	Overall length [mm]:	972
Overall width [mm]:	52	Overall height [mm]:	60

## Mechanical features

Shape:	Rectangular	Housing material:	Aluminium
Diffuser material:	Glass		

## Electrical features

Voltage type:	DC	Power factor / COS $\Phi$ :	>0.9
---------------	----	-----------------------------	------

## Installation

Application area:	Outdoor lighting	Mounting type:	Architectural floodlight
Min. ambient temperature [°C]:	-30	Max. ambient temperature [°C]:	50

## Light features

MacAdam:	3	Lumen maintenance:	L80B10@60000h
Zero light pollution (ULR = 0%):			

**Photometric data**

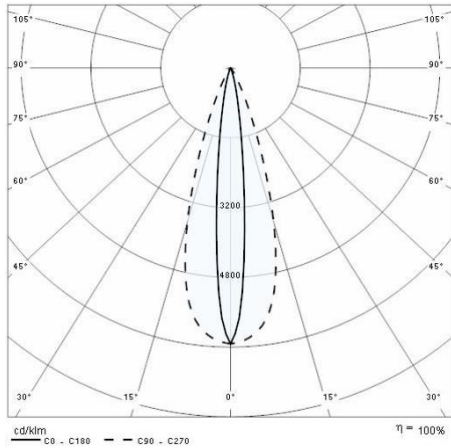

**Control gear**

**NOTTURNO**

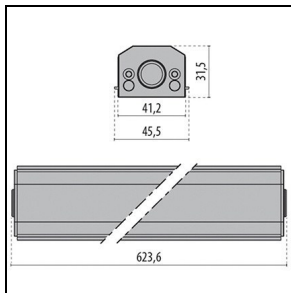

**310543**

Power Supply Unit L1000/1500

**Mandatory accessories**

**NOTTURNO**

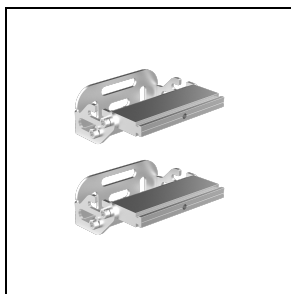

**310523**

Bracket NOTTURNO (nr. 2)

■ GR-11 / Anodised grey

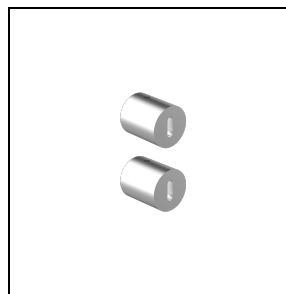

**310524**

Bracket (nr. 2)

■ INOX / Stainless steel

To maintain the regular updating of our products, PERFORMANCE iN LIGHTING reserves the right to make changes without prior notice. For the most up to date information we always recommend you read the latest version published on the website [www.performanceinlighting.com](http://www.performanceinlighting.com). Delivered luminaire lumen outputs and power consumptions, including losses, are subject to a tolerance of +/- 7%, and unless otherwise stated the values apply to an ambient temperature of 25°C. Terms of warranty are available at <https://www.performanceinlighting.com/qr/company/led-warranty>



**310978**

NOTTURNO Telescopic bracket (nr. 2)

■ GR-11 / Anodised grey



**310981**

NOTTURNO ground support bracket (nr. 2)

■ GR-11 / Anodised grey