

ORION V M

Part number 3105441

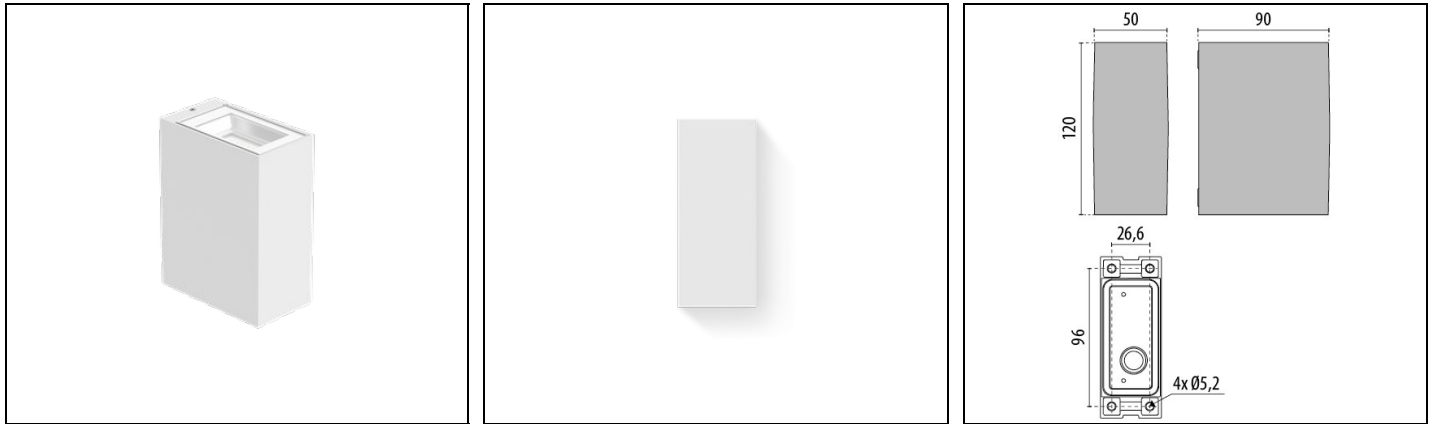

Description

Wall-mounted LED luminaire, comprising:

- Polyester powder coat finish, die-cast aluminium housing, in compact size
- Extra-clear, toughened, flat glass diffuser, silk-screened on the inside
- Aluminium reflector
- Anti-ageing custom moulded silicone sealing gasket(s)
- Driver On Board 220-240V 50/60Hz LED module protected against surges up to 1 kV
- Stainless steel locking hardware

To maintain the regular updating of our products, PERFORMANCE IN LIGHTING reserves the right to make changes without prior notice. For the most up to date information we always recommend you read the latest version published on the website www.performanceinlighting.com. Delivered luminaire lumen outputs and power consumptions, including losses, are subject to a tolerance of +/- 7%, and unless otherwise stated the values apply to an ambient temperature of 25°C. Terms of warranty are available at <https://www.performanceinlighting.com/qr/company/led-warranty>

Product data

| | | | |
|-------------|----------|-------------|----------|
| ETIM Group: | EG000027 | ETIM Class: | EC002892 |
|-------------|----------|-------------|----------|

General information

| | | | |
|------------------------------------|-----------------------------|------------------------------|--------|
| Lampholder: | LED | Light source: | LED |
| Lightsource lumen output [lm]: | 742 | Luminaire lumen output [lm]: | 577.83 |
| Luminaire wattage [W]: | 5 W | Luminous efficacy [lm/W]: | 116 |
| CRI: | 80 | Colour temperature [K]: | 4000 |
| Colour / Finishing: | WH-87 / White / Textured | IP degree of protection: | IP65 |
| Impact resistance / impact energy: | IK06 1J xx3 | Protection class: | I |
| Optic: | S/EW - Symmetric Extra-Wide | Net weight [kg]: | 0.746 |
| Overall length [mm]: | 50 | Overall width [mm]: | 90 |
| Overall height [mm]: | 120 | | |

Mechanical features

| | | | |
|--------------------|-------------|-------------------|-----------|
| Shape: | Rectangular | Housing material: | Aluminium |
| Diffuser material: | Glass | | |

Electrical features

| | | | |
|------------------------------|---------|-----------------------------|---------|
| Voltage type: | AC | Input voltage [V AC]: | 220/240 |
| Input frequency [Hz]: | 50/60 | Power factor / COS Φ : | >0.9 |
| Inrush current [A/ μ s]: | 3 / 136 | C10 1.5 mm ² : | 133 |
| C16 2.5 mm ² : | 173 | B10 1.5 mm ² : | 83 |
| B16 2.5 mm ² : | 133 | | |

Installation

| | | | |
|--------------------------------|------------------|--------------------------------|---------------|
| Application area: | Outdoor lighting | Mounting type: | Exterior wall |
| Min. ambient temperature [°C]: | -20 | Max. ambient temperature [°C]: | 40 |

Light features

| | | | |
|---------------------------------|--------|----------------------------------|---------------|
| MacAdam: | 3 | Lumen maintenance: | L80B10@6680oh |
| Distribution of light emission: | Direct | Zero light pollution (ULR = 0%): | |

To maintain the regular updating of our products, PERFORMANCE IN LIGHTING reserves the right to make changes without prior notice. For the most up to date information we always recommend you read the latest version published on the website www.performanceinlighting.com. Delivered luminaire lumen outputs and power consumptions, including losses, are subject to a tolerance of +/- 7%, and unless otherwise stated the values apply to an ambient temperature of 25°C. Terms of warranty are available at <https://www.performanceinlighting.com/qr/company/led-warranty>

Photometric data

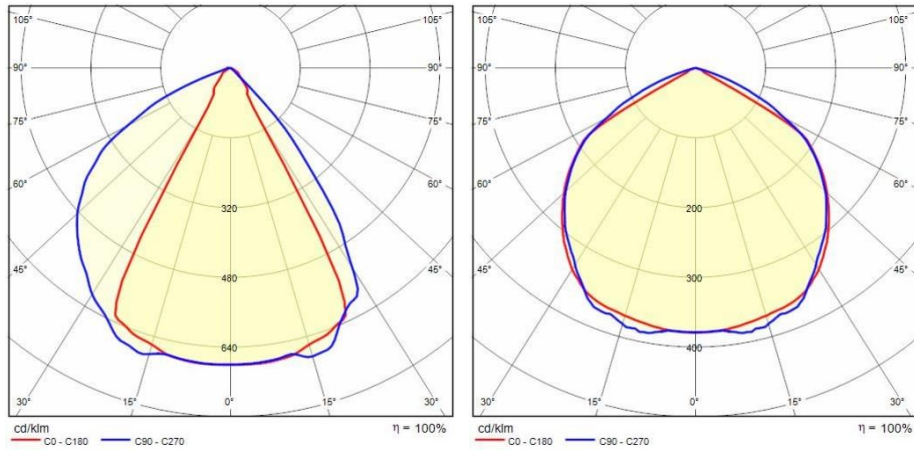

Optional accessories

ORION V

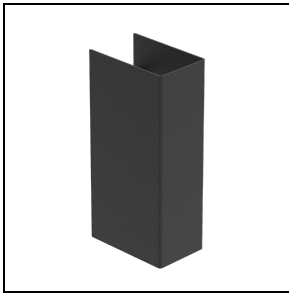

3106287

Carter ORION V

■ BK-81 / Black

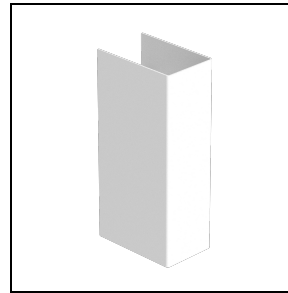

3106286

Carter ORION V

□ WH-87 / White

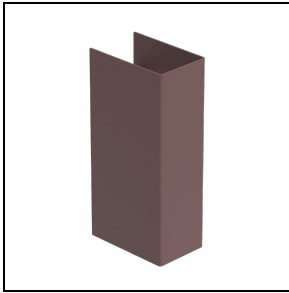

3106288

Carter ORION V

■ RB-10 / Rust