

ORION H M

Part number 3105446

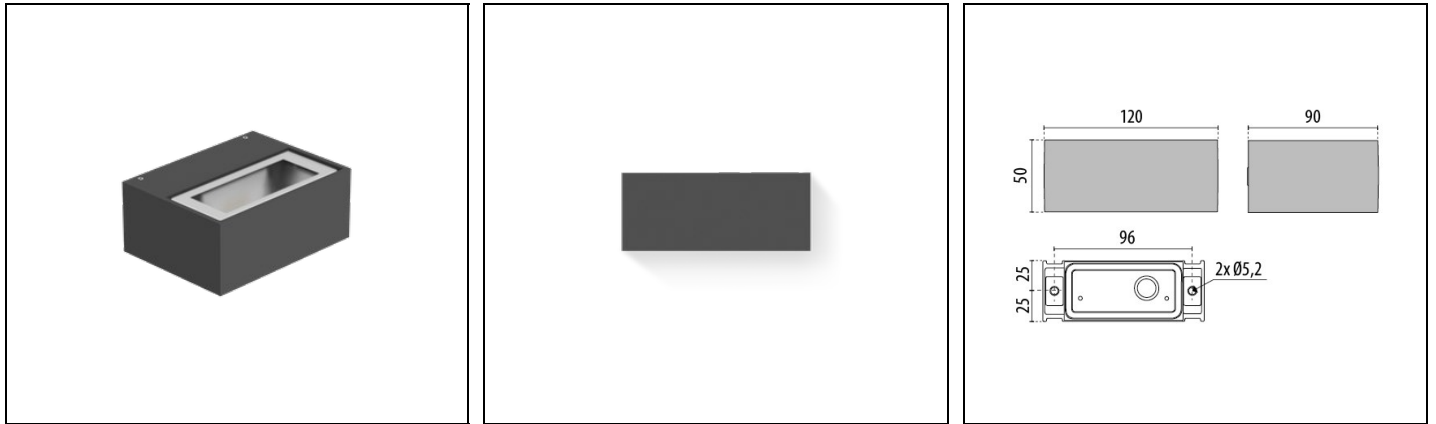

Description

Wall-mounted LED luminaire, comprising:

- Polyester powder coat finish, die-cast aluminium housing, in compact size
- Microprismatic, flat glass diffuser, silk-screened on the inside
- Aluminium reflector
- Anti-ageing custom moulded silicone sealing gasket(s)
- Driver On Board 220-240V 50/60Hz LED module protected against surges up to 1 kV
- Stainless steel locking hardware

To maintain the regular updating of our products, PERFORMANCE iN LIGHTING reserves the right to make changes without prior notice. For the most up to date information we always recommend you read the latest version published on the website www.performanceinlighting.com. Delivered luminaire lumen outputs and power consumptions, including losses, are subject to a tolerance of +/- 7%, and unless otherwise stated the values apply to an ambient temperature of 25°C. Terms of warranty are available at <https://www.performanceinlighting.com/qr/company/led-warranty>

Product data

ETIM Group:	EG000027	ETIM Class:	EC002892
-------------	----------	-------------	----------

General information

Lampholder:	LED	Light source:	LED
Lightsource lumen output [lm]:	675	Luminaire lumen output [lm]:	352.33
Luminaire wattage [W]:	5 W	Luminous efficacy [lm/W]:	70
CRI:	80	Colour temperature [K]:	3000
Colour / Finishing:	AN-g6 / Anthracite gray / Textured	IP degree of protection:	IP65
Impact resistance / impact energy:	IK06 1J xx3	Protection class:	I
Optic:	A/EW - Asymmetric Extra-Wide	Net weight [kg]:	0.622
Overall length [mm]:	120	Overall width [mm]:	90
Overall height [mm]:	50		

Mechanical features

Shape:	Rectangular	Housing material:	Aluminium
Diffuser material:	Glass		

Electrical features

Voltage type:	AC	Input voltage [V AC]:	220/240
Input frequency [Hz]:	50/60	Power factor / COS Φ :	>0.9
Inrush current [A/ μ s]:	3 / 136	C10 1.5 mm ² :	133
C16 2.5 mm ² :	173	B10 1.5 mm ² :	83
B16 2.5 mm ² :	133		

Installation

Application area:	Outdoor lighting	Mounting type:	Exterior wall
Min. ambient temperature [°C]:	-20	Max. ambient temperature [°C]:	50

Light features

MacAdam:	3	Lumen maintenance:	L80B10@6680oh
Distribution of light emission:	Direct	Zero light pollution (ULR = 0%):	

Photometric data

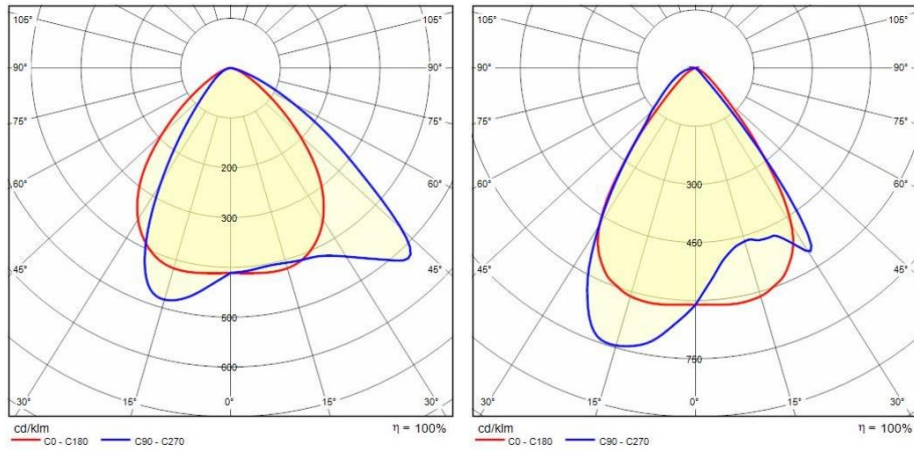

Optional accessories

ORION

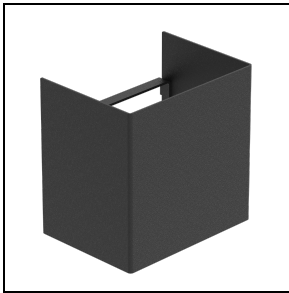

3106290
Carter ORION H
■ BK-81 / Black

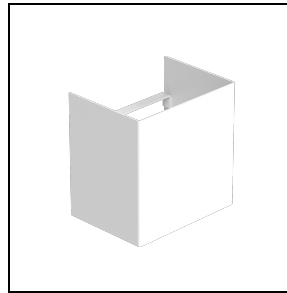

3106289
Carter ORION H
□ WH-87 / White

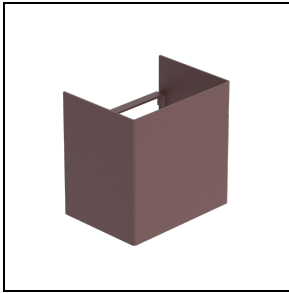

3106291
Carter ORION H
■ RB-10 / Rust