

# LASER+ 30 EXTREME A/M

Part number 3107745



## Description

LED floodlight for indoor and outdoor, comprising:

- Die-cast aluminium bearing structure polyester powder coat finish ISO 9227/12944 - ISO 9223 (C5)
- UV and heat stabilised, technopolymer diffuser with integral custom moulded optics
- High-transparency polycarbonate optics
- Anti-ageing custom moulded silicone sealing gasket(s) with resilient elastic return capacity
- Ultra-high efficiency anodised extruded aluminium heat sink
- Die-cast aluminium electrical connection box polyester powder coat finish ISO 9227/19244 - ISO 9233 (C5)
- IP66-rated, 7 pins PA66 polyamide, socket-plug fast connector for mains connection via power supply unit without opening the luminaire, for cables Ø 13 - Ø 18 mm
- Light beam obtained by the combination of multiple LED modules
- Other colour temperatures (CCT) and colour rendering index (CRI) options available. Consult factory
- Stainless steel locking hardware
- Galvanised powder-coated steel bracket
- All LASER+ power consumption includes power unit losses
- Integral graduated goniometer for aiming purposes
- For LASER+ 20/30 models use only the power supply units available as accessories (ordered separately)
- IP66-rated power control gears available in DALI and DMX-RDM. Maximum distance of 100 m cable length between control gear and luminaire
- Integral surge protection device (SPD) against mains overvoltages up to 10 kV (CM/DM)
- Design by GIORGIO LODI

To maintain the regular updating of our products, PERFORMANCE IN LIGHTING reserves the right to make changes without prior notice. For the most up to date information we always recommend you read the latest version published on the website [www.performanceinlighting.com](http://www.performanceinlighting.com). Delivered luminaire lumen outputs and power consumptions, including losses, are subject to a tolerance of +/- 7%, and unless otherwise stated the values apply to an ambient temperature of 25°C. Terms of warranty are available at <https://www.performanceinlighting.com/qr/company/led-warranty>

## Product data

|             |          |             |          |
|-------------|----------|-------------|----------|
| ETIM Group: | EG000027 | ETIM Class: | EC001744 |
|-------------|----------|-------------|----------|

## General information

|                                    |                                  |                          |        |
|------------------------------------|----------------------------------|--------------------------|--------|
| Lampholder:                        | LED                              | Light source:            | LED    |
| Lightsource lumen output [lm]:     | 181000                           | Luminaire wattage [W]:   | 1592 W |
| CRI:                               | 90                               | Colour temperature [K]:  | 5700   |
| Colour / Finishing:                | GR-94 / Metallic grey / Textured | IP degree of protection: | IP66   |
| Impact resistance / impact energy: | IK09 13J xx7                     | Protection class:        | I      |
| Optic:                             | A50/M - Asymmetric Medium        | Beam angle:              | 50°    |
| Net weight [kg]:                   | 32.917                           | Overall length [mm]:     | 710    |
| Overall width [mm]:                | 796                              | Overall height [mm]:     | 440    |

## Mechanical features

|   |             |   |           |
|---|-------------|---|-----------|
| Shape:                                  | Rectangular | Housing material:                       | Aluminium |
| Diffuser material:                      | Plastic     | Glow wire test [°C]:                    | 960 °C    |
| Frontal exposed area [m <sup>2</sup> ]: | 0.1         | Lateral exposed area [m <sup>2</sup> ]: | 0.09      |
| Top exposed area [m <sup>2</sup> ]:     | 0.51        |   |           |

## Electrical features

|                             |      |
|-----------------------------|------|
| Power factor / COS $\Phi$ : | >0.9 |
|-----------------------------|------|

## Installation

|  |                  |                                |                         |
|--|------------------|--------------------------------|-------------------------|
| Application area:                      | Outdoor lighting | Mounting type:                 | Professional floodlight |
| Min. ambient temperature [°C]:         | -40              | Max. ambient temperature [°C]: | 50                      |
| Min. distance from lighted object [m]: | 1.00             |                                |                         |

## Light features

|                                  |        |                           |               |
|----------------------------------|--------|---------------------------|---------------|
| MacAdam:                         | 5      | Lumen maintenance:        | L80B10@72000h |
| Distribution of light emission:  | Direct | Luminous Intensity Class: | G*6           |
| Zero light pollution (ULR = 0%): |        |                           |               |

To maintain the regular updating of our products, PERFORMANCE IN LIGHTING reserves the right to make changes without prior notice. For the most up to date information we always recommend you read the latest version published on the website [www.performanceinlighting.com](http://www.performanceinlighting.com). Delivered luminaire lumen outputs and power consumptions, including losses, are subject to a tolerance of +/- 7%, and unless otherwise stated the values apply to an ambient temperature of 25°C. Terms of warranty are available at <https://www.performanceinlighting.com/qr/company/led-warranty>

## Control gear

---

### LASER+ 30 EXTREME

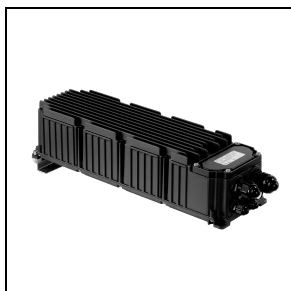

**3109421**  
Driver box 1500 - 1.4 A - 3 CH - DALI



**3109422**  
Driver box 1500 - 1.4 A - 3 CH - DMX

## Optional accessories

---

### LASER+ 30 EXTREME

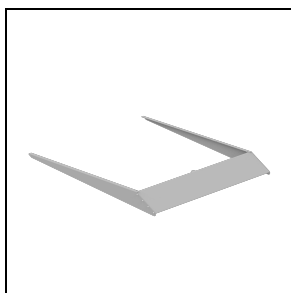

**3115079**  
Louvre LASER+ 30 - 5°  
■ GR-94 / Metallic grey

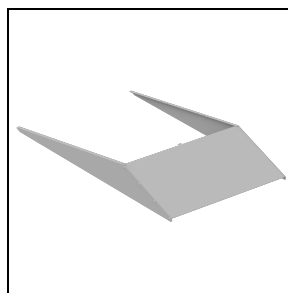

**3115080**  
Louvre LASER+ 30 - 10°  
■ GR-94 / Metallic grey

### LASER+ EXTREME

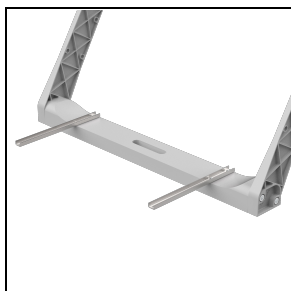

**3117476**  
Brackets supports for driver  
■ INOX / Stainless steel

### LASER+ EXTREME A

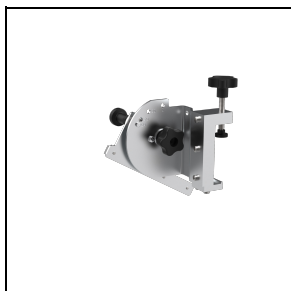

**3116553**  
Pointer support