

ROAD [5] MINI 1X3 LED WIDE

Part number GWR5271M

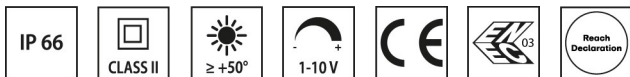
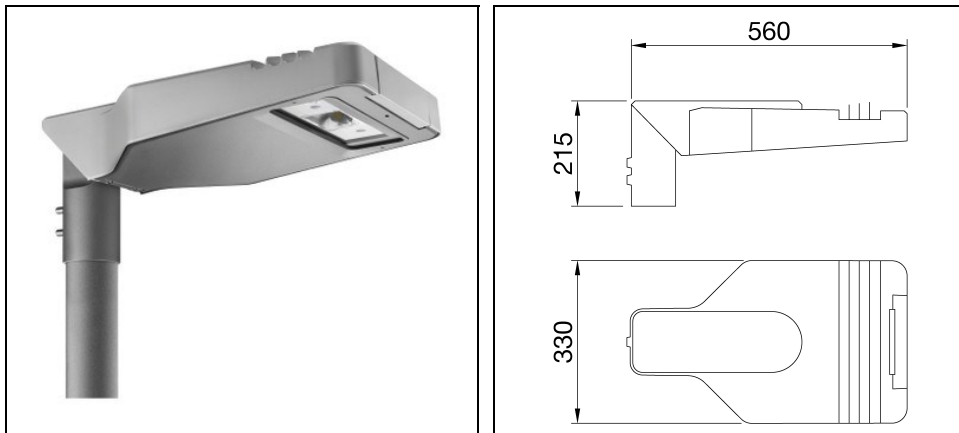

Description

Street lighting device with cover, frame, and pole attachment in EN AB 46100 die-cast aluminium with low copper content:

- Polyester powder coated
- High-power LED
- Printed Circuit Board (PCB) in metal core
- Common mode surge protection up to 10kV
- With safety switch
- Cable plate in PA6.6 + glass fiber
- Cable input via PG13,5 cable gland
- High reflective aluminium optical system
- Tempered flat glass with 4 mm thickness
- Opening and closing system with integrated front handle
- It can be used up to 50°C of ambient temperature but with reduced currents as indicated in the instruction manual
- Suitable for installation both on top of the pole and offset with 5° pitch adjustment
- L90B10 (Tq 25°C) > 115.000 h; L90B10 (Tq 50°C) = 115.000 h

Product data

ETIM Group:	EG000027	ETIM Class:	EC000062
-------------	----------	-------------	----------

General information

Lampholder:	LED	Light source:	LED
Luminaire lumen output [lm]:	3700	Luminaire wattage [W]:	26 W
Luminous efficacy [lm/W]:	142	CRI:	70
Colour temperature [K]:	4000	Colour / Finishing:	GR-RAL9006 / Grey RAL9006
IP degree of protection:	IP66	IK-J-xxIP:	IK08 5J xx5
Protection class:	II	Optic:	WIDE - Street
Net weight [kg]:	6.554	Overall length [mm]:	560
Overall width [mm]:	330	Overall height [mm]:	215

Mechanical features

Housing material:	Aluminium	Diffuser material:	Glass
-------------------	-----------	--------------------	-------

Electrical features

Voltage type:	AC	Input voltage [V AC]:	220/240
Input frequency [Hz]:	50/60		

Installation

Application area:	Outdoor	Mounting type:	Street lighting
Min. ambient temperature [°C]:	-25	Max. ambient temperature [°C]:	50

Light features

MacAdam:	5	Lumen maintenance:	L90B10@115000h
Distribution of light emission:	Direct	UGR max.:	0.0
Luminous Intensity Class:	G*4	IPEA* (road lighting):	A8+
IPEA* (large areas, roundabouts):	A9+	IPEA* (cycle-pedestrian):	A7+
IPEA* (green areas):	A6+	IPEA* (historic city centers):	A12+

Photometric data

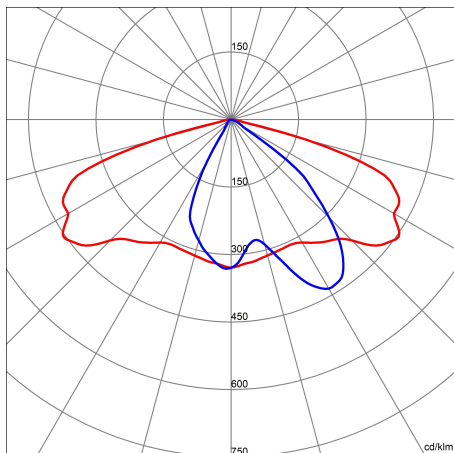

Optional accessories

ROAD [5] MINI



GWR5191

Visor - graphite grey

■ Graphite grey / Graphite grey



GW86167

Wall-mounting bracket 150x160x290 mm - graphite grey

■ Graphite grey / Graphite grey



GW87581

Single pole head bracket 1 m - graphite grey

■ Graphite grey / Graphite grey

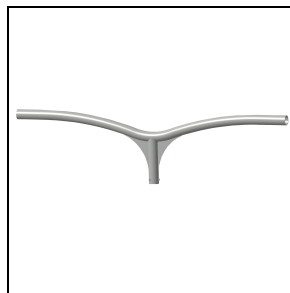

GW87582

Double pole head bracket 1+1 m - graphite grey

■ Graphite grey / Graphite grey

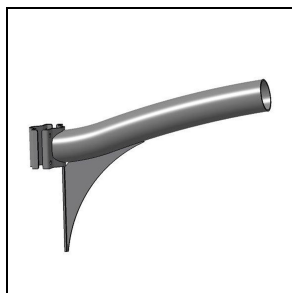

GW87587

Short bracket 0,5 m - graphite grey

■ Graphite grey / Graphite grey

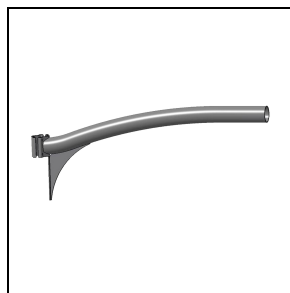

GW87586

Long bracket 1 m - graphite grey

■ Graphite grey / Graphite grey



GW84096

Conical pole painted h = 5.5 m -
graphite grey

■ Graphite grey / Graphite grey



GW87591

Conical pole painted h = 6.8 m -
graphite grey

■ Graphite grey / Graphite grey



GW84097

Conical pole painted h = 7.8 m -
graphite grey

■ Graphite grey / Graphite grey



GW87592

Conical pole painted h = 8.8 m -
graphite grey

■ Graphite grey / Graphite grey

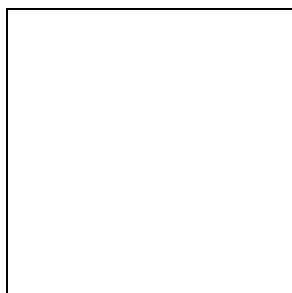

GW87593

Conical pole painted h = 9.8 m -
graphite grey

■ Graphite grey / Graphite grey